



THE ANSWER TO IDEAL LIVING

PRODUCT INSTALLATION MANUAL

WHEN IT COMES TO HOME, THIS IS THE BEST ANSWER.

LED Oval Bathroom Mirror

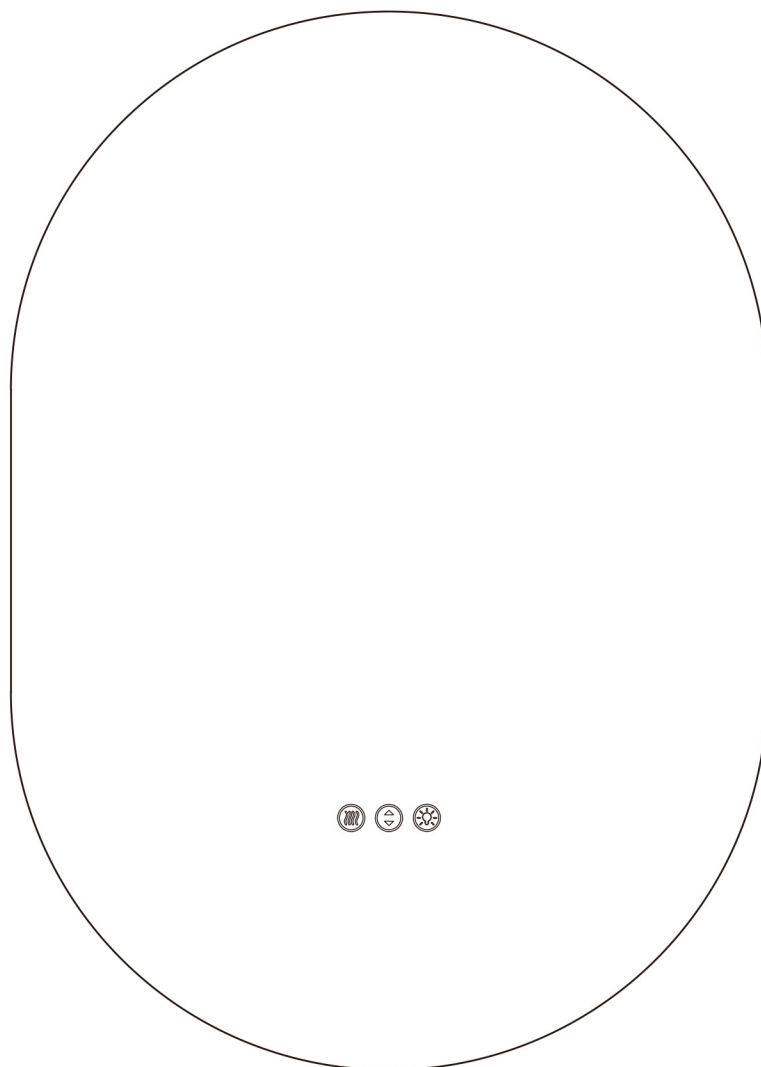

(After-Sale Service: Please email us if any question.)

User Manual

Product Specifications

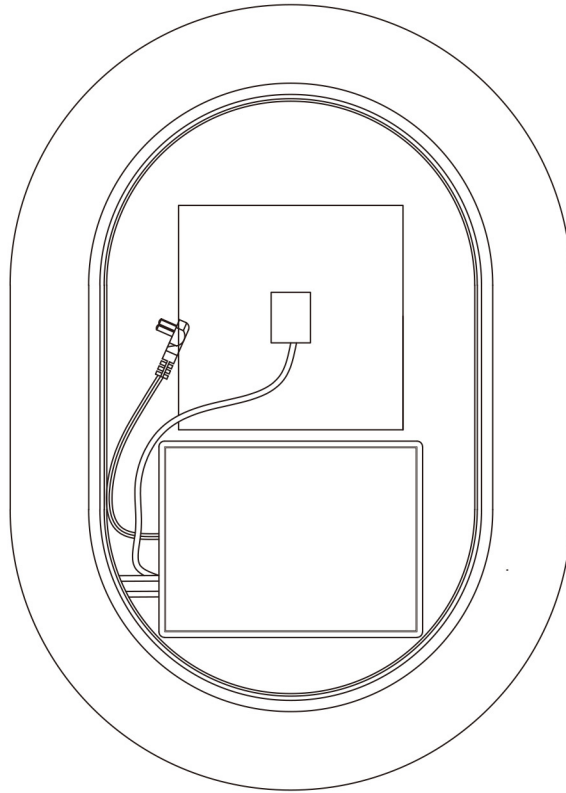

Accessories

 7.8"	1PCS		2PCS
---	------	---	------

1.18"

Size	Thickness	Touch Button	LED Strip Mode	Color Temperature	Lumen	CRI	Life Span	Power (W)	Input Voltage(V)	Output Voltage(V)	Weight (kg)
20"X28"	1.18"	3	2835 3 colors 120LED	3000k/4000k /6000k	1650	≥90 Ra	≥50000 hours	24W	120V, 50/60HZ	24V	5.58
20"X30"	1.18"	3	2835 3 colors 120LED	3000k/4000k /6000k	1760	≥90 Ra	≥50000 hours	24W	120V, 50/60HZ	24V	6.06
20"X32"	1.18"	3	2835 3 colors 120LED	3000k/4000k /6000k	1870	≥90 Ra	≥50000 hours	24W	120V, 50/60HZ	24V	6.37
20"X36"	1.18"	3	2835 3 colors 120LED	3000k/4000k /6000k	2090	≥90 Ra	≥50000 hours	24W	120V, 50/60HZ	24V	7.17
24"X36"	1.18"	3	2835 3 colors 120LED	3000k/4000k /6000k	2200	≥90 Ra	≥50000 hours	24W	120V, 50/60HZ	24V	8.6
28"X36"	1.18"	3	2835 3 colors 120LED	3000k/4000k /6000k	2310	≥90 Ra	≥50000 hours	24W	120V, 50/60HZ	24V	10.04
20"X40"	1.18"	3	2835 3 colors 120LED	3000k/4000k /6000k	2310	≥90 Ra	≥50000 hours	24W	120V, 50/60HZ	24V	7.9
24"X40"	1.18"	3	2835 3 colors 120LED	3000k/4000k /6000k	2420	≥90 Ra	≥50000 hours	24W	120V, 50/60HZ	24V	9.23
28"X40"	1.18"	3	2835 3 colors 120LED	3000k/4000k /6000k	2530	≥90 Ra	≥50000 hours	36W	120V, 50/60HZ	24V	11.16
30"X40"	1.18"	3	2835 3 colors 120LED	3000k/4000k /6000k	2640	≥90 Ra	≥50000 hours	36W	120V, 50/60HZ	24V	11.9
24"X48"	1.18"	3	2835 3 colors 120LED	3000k/4000k /6000k	2860	≥90 Ra	≥50000 hours	36W	120V, 50/60HZ	24V	12.1
30"X48"	1.18"	3	2835 3 colors 120LED	3000k/4000k /6000k	2970	≥90 Ra	≥50000 hours	36W	120V, 50/60HZ	24V	12.7

Troubleshooting



Warm Tips:

- 1.Please check the mirrors firstly after you receive it and make sure the led mirror is intact and no damage. The accessories are hanging behind the mirror, please recheck the packing box if you did not find it.
- 2.Please power the mirror with plug to test the mirror and each functions before installation. If it can not be powered, please open the cover of the power supply on the back of the mirror to test the power cables, tighten the cables if they are loose. (Please cut off the power firstly before testing the power supply and cables)
- 3.For any questions or problems, please feel free to contact us.

<p>LED doesn't turn on / Defogging doesn't work</p>	<p>Open the power box on the back of the mirror and test the power cables, tighten the cables if they are loose. (Please cut off the power firstly before testing the power supply and cables).</p>
<p>Part of light strip is fault</p>	<p>Firstly, please pull the outer silicone strip away and press the inner light strip inward. If it still doesn't work, need replace the strip light.</p>
<p>After using for a few month, the light doesn't work.</p>	<p>Please contact us to replace the power supply.</p>

Installation Instruction

Method 1: Plug in



Insert the plug into the socket, keep the voltages between 110V and 120V. If the voltage exceeds 120V, please use transformer.

Method 2: Hardwire

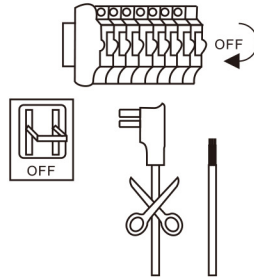

There are two power wires behind the mirror

Neutral Wire (Usually white, red or blue.)

Live Wire (Usually black or dark brown.)

Cut the plug, connect the same color wire and tighten them (Disconnect power before hardwire).

Step 1

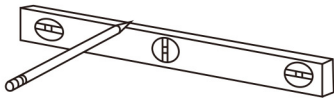

Draw a straight line with a ruler to keep the mirror horizontal

Step 2

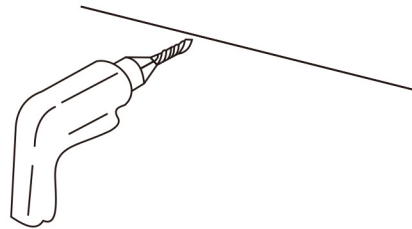

Use a electric drill to punch four holes at the marked spots.

Step 3

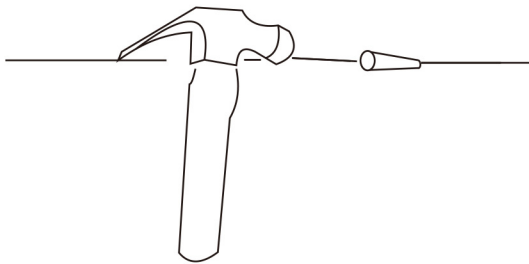

Apply wall anchors with hammer.

Step 4

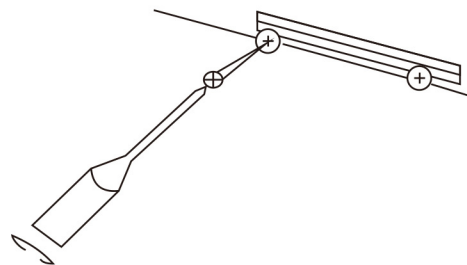

Use a screwdriver to screw the screws into the wall anchors.

Step 5

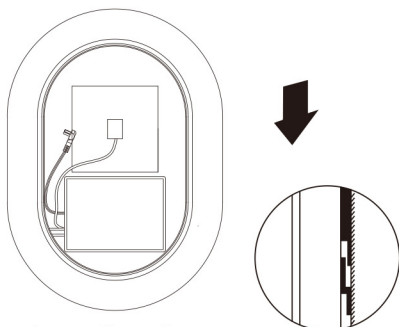

Hang the mirror on the wall

Step 6

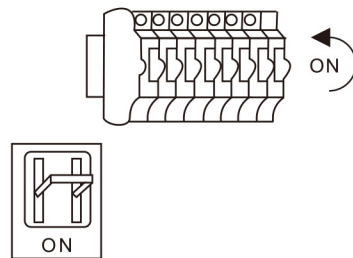

Turn on the power.



THE ANSWER TO IDEAL LIVING



Call us (9-8 EST): +1 888-257-3857

Email us (24/5) : service@casainc.com

Message us : +1 562-551-8092

For sales : dtc@casainc.com