

# ASSEMBLY INSTRUCTIONS - DOUBLE OVEN CABINET

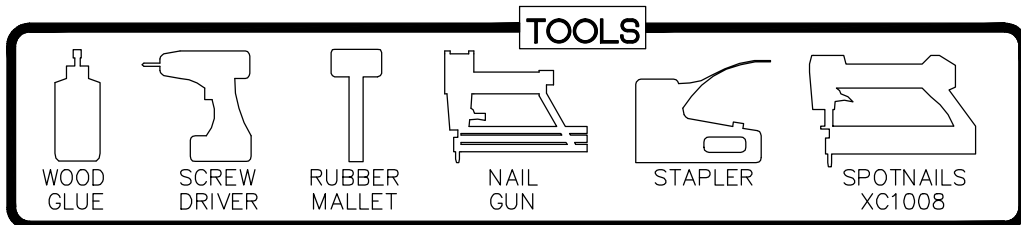
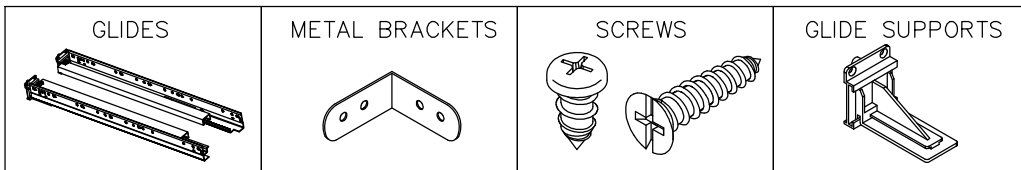
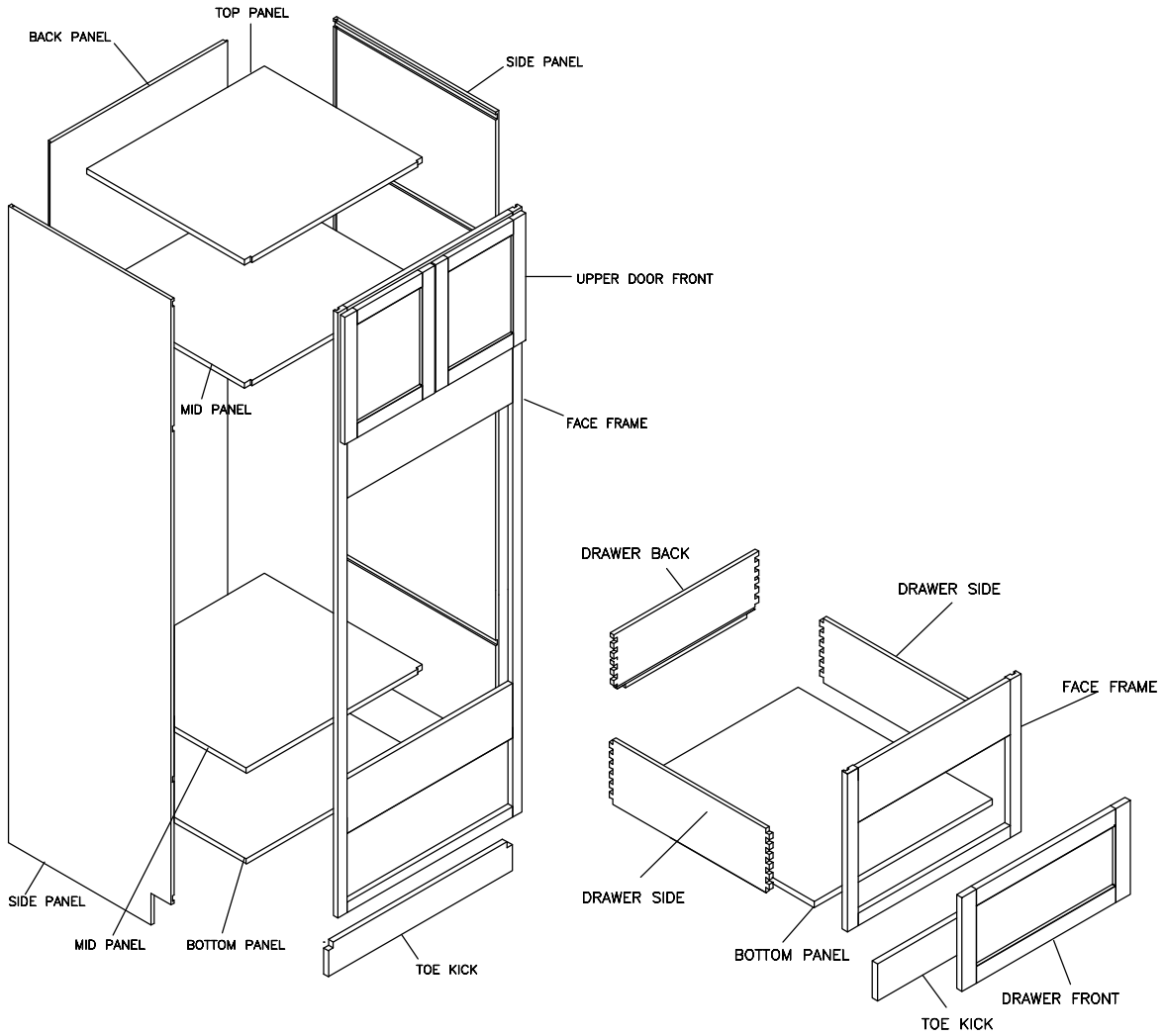

This instruction applies to the following items:  
 OVD338427, OVD339027, OVD339627

STEP 1

Glue each assembly slot

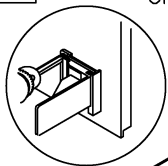

SCREW DRIVER

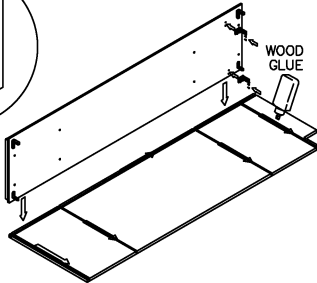

STEP 2

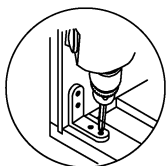

WOOD GLUE

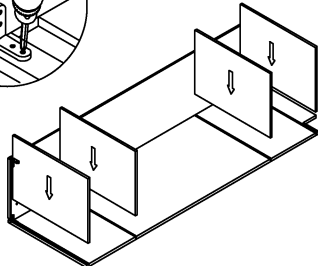

STEP 3

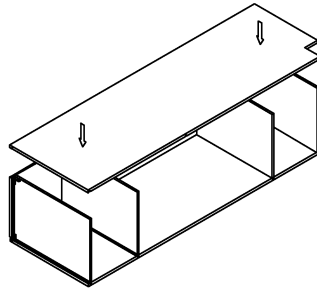

STEP 4

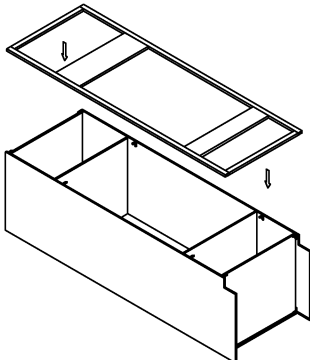

STEP 5

NAIL GUN

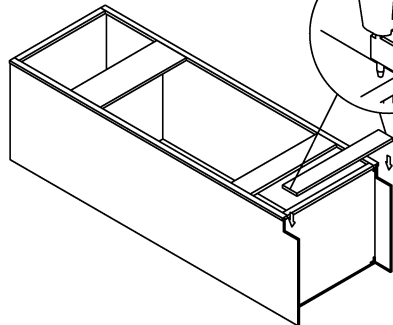
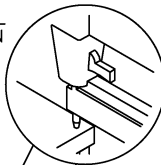

STEP 6

SCREW DRIVER

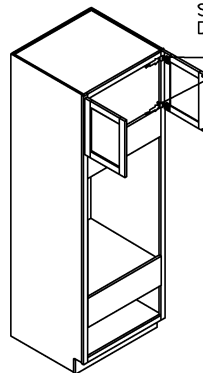
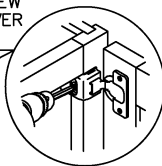

STEP 7

NAIL GUN

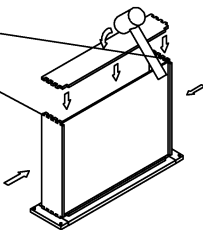
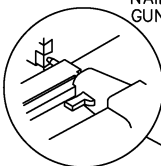

STEP 8

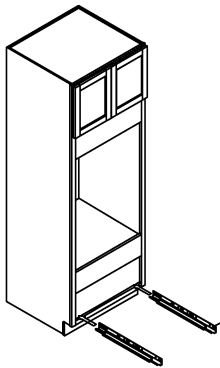
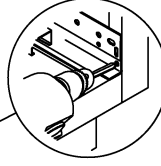
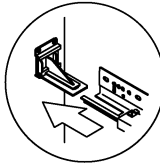

STEP 9

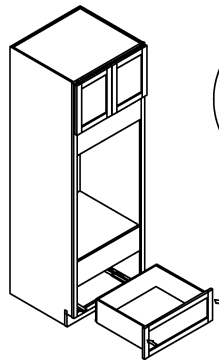
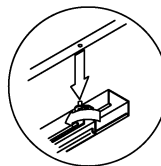

STEP 10

